

NORTON

SAINT-GOBAIN

clipper[®]

Transforming
surfaces
...and beyond

DUST EXTRACTOR CV 200 UNO D

USER MANUAL

Translated instruction manual





CE Declaration of Conformity

The undersigned manufacturer:

SAINT - GOBAIN ABRASIVES S.A.
190 KENNEDY BD. J. F.
L-4930 BASCHARAGE

Declares that the following new equipment:

Vacuum cleaner: **DUST EXTRACTOR CV 200 UNO 230V D** Code: **70184633819**

complies with the provisions of the Guidelines:

- **"Machinery" 2006/42/EC**
- **"Electromagnetic compatibility" 2014/30/EU**

And to the European standard:

- **EN ISO 12100**
- **EN 60334-1**
- **EN 60335-2-69**
- **EN 61000-6-2**
- **EN 61000-6-4**

Valid for machines with serial number from: 4503655986001

Where technical documents are kept:

Saint-Gobain Abrasives 190, Bd. J. F. Kennedy 4930 BASCHARAGE, LUXEMBOURG

This declaration of conformity becomes null and void if the product is processed or modified without our consent.

Bascharage, 20.01.2025.

Fabrice Genuardi, authorised representative and responsible for the technical file.
Bascharage, Luxembourg.



Filtration declaration

The undersigned manufacturer:

SAINT - GOBAIN ABRASIVES S.A.
190 KENNEDY BD. J. F.
L-4930 BASCHARAGE

Declares that the following new equipment:

Vacuum cleaner: **DUST EXTRACTOR CV 200 UNO 230V D**

Code: **70184633819**

Certified : **Filtration class H**



N° test report: SUES241100180401 (SGS)

Valid for machines with serial number from: 4503430198001

Bascharage, 20.01.2025.

Fabrice Genuardi, authorised representative and responsible for the technical file.
Bascharage, Luxembourg.

**CV 200 D
USER MANUAL
TABLE OF CONTENTS**

<u>1</u>	<u>Introduction</u>	<u>8</u>
<u>2</u>	<u>Guarantee</u>	<u>8</u>
<u>3</u>	<u>Safety instructions</u>	<u>9</u>
<u>4</u>	<u>Machine data.....</u>	<u>11</u>
4.1	<i>Machine Description</i>	11
4.2	<i>Technical data</i>	13
4.3	<i>Machine insert</i>	14
4.4	<i>Thermal protection.....</i>	14
4.5	<i>Grounding instruction.....</i>	14
4.6	<i>Safety label</i>	14
<u>5</u>	<u>Performance Tolerances.....</u>	<u>15</u>
<u>6</u>	<u>Installation</u>	<u>15</u>
<u>7</u>	<u>Using the vacuum cleaner</u>	<u>16</u>
7.1	<i>Function.....</i>	16
7.2	<i>Filter Cleaning</i>	17
7.3	<i>Dust storage system</i>	18
7.4	<i>Filter Replacement</i>	19
<u>8</u>	<u>Maintenance.....</u>	<u>20</u>
<u>9</u>	<u>End of Product Life</u>	<u>20</u>
<u>10</u>	<u>Breakdowns – Cause and Repair</u>	<u>21</u>
10.1	<i>Fault Tracking.....</i>	21
10.2	<i>After-sales service.....</i>	22
10.3	<i>Parts</i>	23

1 Introduction

This operation and maintenance manual sets out the guidelines and procedures to be followed by operators of this equipment to ensure:

- Operator Safety
- Correct use of the machine
- Optimal performance

IT IS NECESSARY THAT AUTHORIZED PERSONNEL AND THE MACHINE OPERATOR HAVE READ AND UNDERSTOOD THE MANUAL BEFORE OPERATING THE MACHINE.

Because of the importance of this information, it is recommended to:

- Always keep this manual handy for easy reference
- Keep the manual in a safe place to avoid loss or damage
- Ask the manufacturer/supplier for a copy in case of loss or damage
- Provide this manual and the manufacturer's details with the machine if it is sold to a third party.

The manufacturer reserves the right to update its products and manuals and is under no obligation to provide updated versions thereof.

2 Guarantee

The vacuum cleaners manufactured by Saint-Gobain Norton Clipper have been fully inspected to ensure proper electrical, pneumatic and mechanical operation. The vacuums are covered by a 12-month warranty. All defective parts of the machine are covered by the warranty, but this does not include parts damaged during shipping, handling, or use, nor does it cover parts damaged by normal wear and tear.

Repairs can be carried out by an authorized service center or directly by Saint-Gobain Norton Clipper.

To request your warranty service, you must send a written request to the dealer or directly to the manufacturer, including manufacturing details which can be found on a plate inside your machine along with a copy of the invoice.

The warranty is not valid under the following conditions:

- Improper use of the machine or total or partial non-compliance with the contents of this manual
- Any part of the vacuum cleaner is altered or altered in any way
- Incorrect electrical installation
- If the laws of the country of use are not complied with
- Inadequate maintenance
- The machine has not undergone routine maintenance as specified in this manual
- Use of spare parts that are not produced by Saint-Gobain Norton Clipper or that are not specifically indicated for the model used

3 Safety instructions

When using an electrical appliance, basic precautions should always be followed, including the following:

WARNING – To reduce the risk of fire, electric shock or injury:

- Cables damaged through crushing or splitting can be dangerous if used and should be replaced immediately. Risk of personal injury.
- Make sure the assembly area is firm, so the dust extractor does not tip over. Risk of personal and material injury.
- Risk of pinching when handling the toggle fasteners.
- The machine must not be used in environments where explosive gases may be present. Serious risk of explosion.
- Improper connection of the equipment-grounding conductor can result in a risk of electrical shock. Check with a qualified electrician or service person if you are in doubt as to whether the outlet is properly grounded. Do not modify the plug provided with the machine. If it will not fit the outlet. Have a proper outlet installed by a qualified electrician.
- Before using the machine, make sure that the power & voltage corresponds with the voltage shown on the machines rating plate.
- Do not leave machine when plugged in. Unplug cord from outlet when not in use and before cleaning or servicing machine.
- Do not use outdoors or on wet surface, this machine is for indoor and dry use only.
- Do not allow to use as a toy. Close attention is necessary when used by or near children.
- Use only as described in this manual. Use only manufacturers recommended attachments.
- Operators shall be adequately instructed on the use of the machine.
- This machine is not intended for use by persons (including children) with reduced physical, sensory or mental capabilities, or lack of experience and knowledge.
- Do not use with damaged cord or plug. If the machine is not working as it should, has been dropped, damaged, left outdoors or dropped in water. Make sure it is repaired by a qualified person.
- Do not pull or carry by cord, use cord as handle, close a door on cord, or pull cord around sharp edges or corners. Do not run the machine over cord. Keep cord away from heated surfaces.
- Do not unplug by pulling on cord. To unplug, grasp the plug. Not the cord.
- Do not handle plug or machine with wet hands.
- Regularly inspect cord and plug for damage. If cord is damaged, it must be replaced by a qualified person in order to avoid hazard.
- Do not put any object into openings. Do not use with any opening blocked (accept during filter cleaning procedure). Keep free of dust, hair and anything that may reduce airflow.
- Keep hair, loose clothing, fingers and all parts of body away from openings and moving parts.
- Turn off all controls before unplugging.
- Do not use to pick up flammable or combustible liquids, such as gasoline, or use in areas where they may be present.
- Do not pick up any type of liquids.
- Do not pick up anything that is burning or smoking, such as cigarettes, matches or hot ashes.
- Use extra care when cleaning on stairs.

- Do not use without dust bag and/or filters in place. Replace collection system and/or filters as described in manual.
- If using an extension cord make sure the cord rating is suitable for this machine.
- Do not modify machine from its original design.
- Keep children and unauthorized persons away from machine when in use.
- All repairs must be performed by a qualified service person. Use only manufacturer-supplied or equivalent replacement parts.
- Do not expose machine to rain or moisture. Store indoors only.
- Connect to a properly grounded outlet only. See grounding instructions.

4 Machine data

4.1 Machine Description

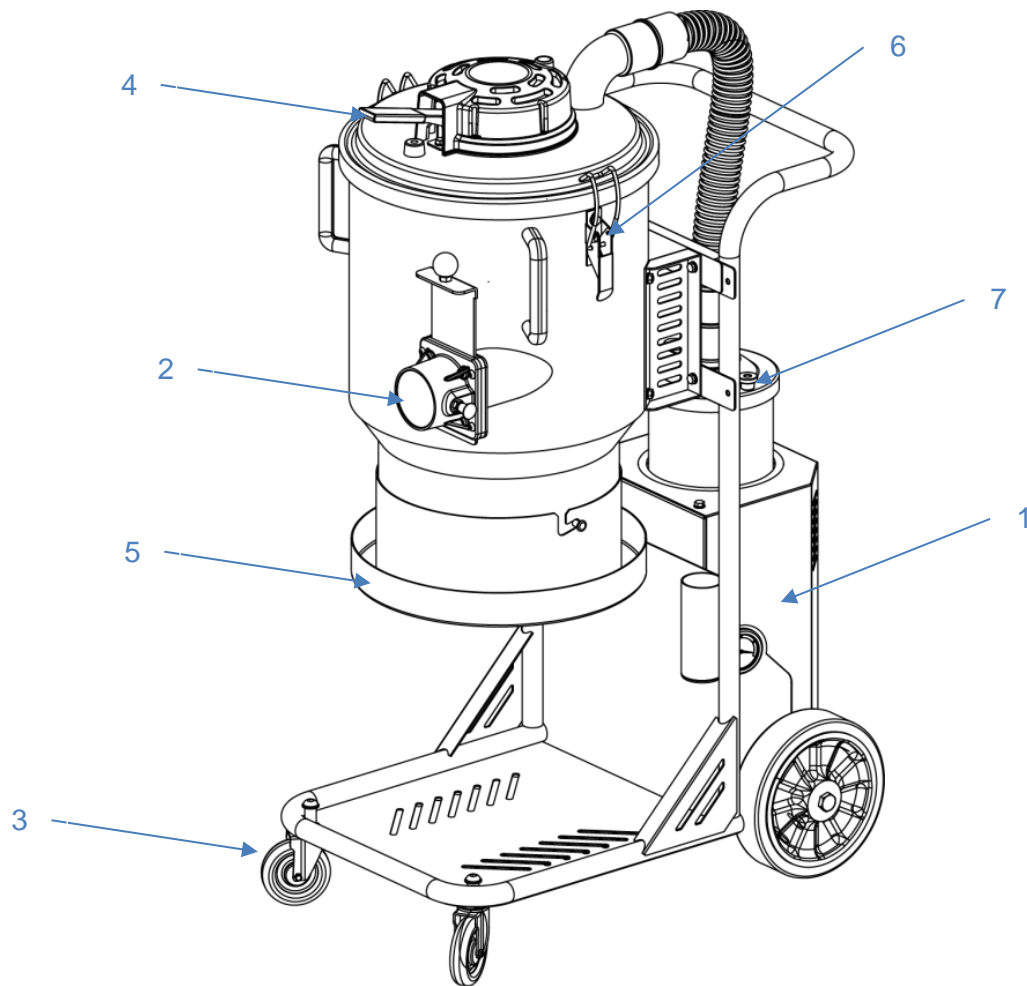

1	Suction unit
2	Connecting Accessories
3	Wheels
4	Filter Cleaning Lever
5	Bag holder
6	Accessing the Main Filter
7	Accessing the Secondary Filter

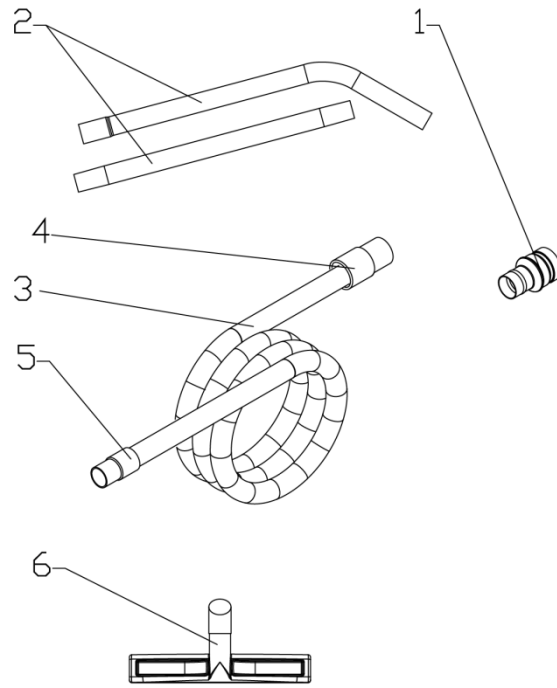

1	Reducer
2	Vacuum cleaner handle
3	Hose Ø38 length 5m
4	Vacuum cleaner nozzle
5	Nozzle for vacuum cleaner handle
6	Brush

4.2 Technical data

Data	Unit	CV 400 UNO 230V	CV 400 UNO 110V
Voltage	V	220V-240V	110-120V
Power (max)	KW	1.2	1.2
	HP	1.6	1.6
Current (UL)	A	4	9
Airflow (max)	m ³ /h	200	200
Vacuum (Max)	mbar	240	240
Main hose	mm	5m x D38	
	"	13' x 1.5"	
Inlet	mm	50	
	"	2"	
Pre filter EN 779-F8	%@1µm	99.5%	
Pre filter area	m ²	1.7	
	ft ²	18	
HEPA filter EN1833-H13	%@0.3µm	99.99%	
H13 HEPA filter area	m ²	1.2	
	ft ²	13	
Dust collection system	Type	Sac continu	
Dimensions (L*W*H)	mm	420 x 680 x 1100	
	"	16.5 x 26.7 x 43.3	
Weight	kg	30	
	lbs	67	

4.3 Machine insert

Each Saint-Gobain Norton Clipper machine carries an identification plate with the essential details needed to contact the supplier/manufacturer for advice, suggestions, or aftermarket information.

The following details can be found on the plaque:

- Maker
- Model
- Serial Number
- Supply voltage
- Nominal installed power
- CE symbol (manufactured in accordance with the Machinery Directive 2006/42/EEC) and UKCA

4.4 Thermal protection

The dust extractor is equipped with a safety thermal protector to prevent motor from overheating. Should thermal protector activate, turn off machine, unplug power cord and check for full dust bag, vacuum hose clog or filter blockage. It may take up to 45 minutes for the thermal protector to reset.

4.5 Grounding instruction

The dust extractor must be grounded. If it should malfunction or breakdown, grounding provides a path of least resistance for electric current to reduce the risk of electric shock. The dust extractor is equipped with a cord having an equipment-grounding conductor and grounding plug. The plug must be inserted into an appropriate outlet that is properly installed and grounded in accordance with all local codes and ordinances.

4.6 Safety label

The following label appears in front of the machine. Check all the details stated in the label before using. Replace label if it is missing, becomes damaged or illegible. Failure to follow this warning label may result in fire, electric shock, or injury.

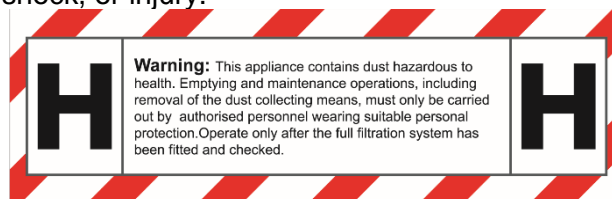

5 Performance Tolerances

The performance of the turbine can vary by 15% depending on the temperature and humidity of the air.

6 Installation

When unpacking the machine, please check that the following accessories are included:

- The hose with end fittings
- Wand
- Floor brush

If any of the above-mentioned parts are missing, please contact your local distributor or our sales representative. For models that do not already have the front casters assembled due to packaging limitations. Assemble the front casters using the using bolt or nut and washer that are included in the package depending on your application. Protect the environment:

Please dispose of packaging materials and used machine components in an environmentally safe way according to local disposal regulations. Always remember to recycle.

To assemble the accessories:

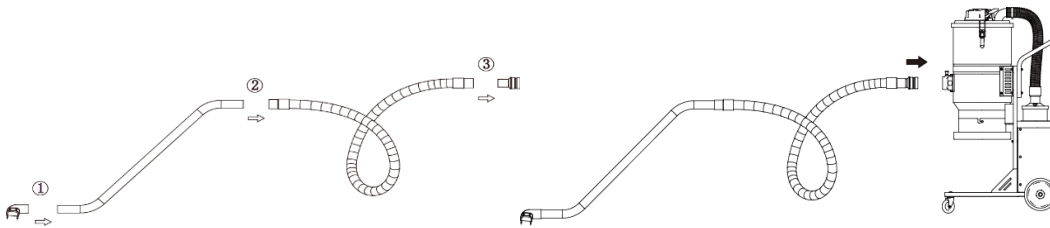

1. Connect the floor brush and wand
2. Connect the Wand and hose
3. Connect the hose and adaptor
4. Connect the accessories kit and the inlet

Note: Don't rolling or twisting the hose when working.

7 Using the vacuum cleaner

7.1 Function

The machine is designed for vacuuming and separating dry, non-combustible dust with an explosion limit value of $0.1\text{mg}/\text{m}^3$.

The dust extractor is started by the switch. All the switches can operate independently.

Type: Models with Jet pulse filter cleaning

Switch 2 step: 0: Motor off, 1: Motor on



Notice: Before connecting the power, please confirm the voltage is consistent with the label on the machine.

- Make sure the electric plug and socket are matching.
- Make sure the hose and inlet are matching.
- Connect the accessories and hose end.



Notice

- Turn on the machine until the motor stop working completely.
- Please disconnect the plug when the machine doesn't work.

Dust-laden air is then sucked through the inlet valve at high speed via the suction hose. The air is slowed down by the cyclone and coarse dust particles are separated out, partly by centrifugal force and partly by gravity. Air and finer particles then pass through the double filter system where separation is made. The machine is designed for filter cleaning by reverse air pulse.

The separated dust accumulates in the cyclone until the machine is switched off, when it drops through the bottom flap into the plastic bag. The filter cleaning process is not completed before it is clear that the dust inside the tank has fallen down into the collection bag. In some extreme cases the adhesive ability of the dust must be broken manually. This can be done by hitting the dust through the bag or tapping the tank using i.e. a rubber hammer.

7.2 Filter Cleaning

The filter must be cleaned from time to time. This must be done before changing the bag collection system and should also be done when work is completed or when there is poor suction.

Procedure:

1. Cover the stopper, block the inlet.
2. Turn on the machine and wait 3 seconds, let the machine build up vacuum.
3. Quickly push down on the key and wait 3 seconds.
4. Repeat the procedure five times.
5. Turn off the motor and wait until it stops completely, then uncover the inlet.

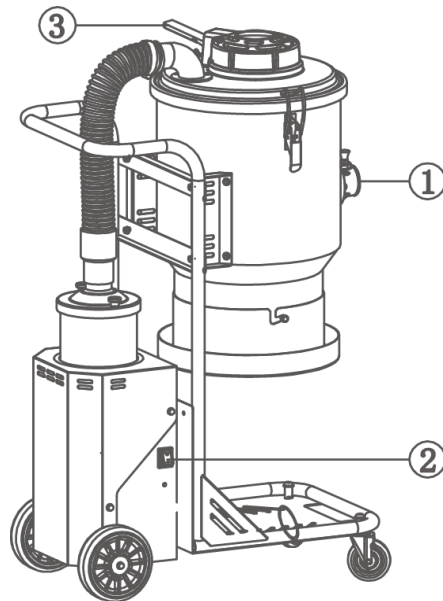

!!! It is important to let the machine rebuild the vacuum in between every repetition.

If suction remains poor, the pre-filter needs to be replaced. If suction still remains poor afterwards, the HEPA filters needs to be replaced.

7.3 Dust storage system

The dust extractors are mainly equipped with continuous folding bagging system for effective dust storage or a regular plastic bag system depending on model. The continuous bag is a 20 m long plastic tube that will be divided into plastic bags using the zip ties attached with the machine.

To assemble a new continuous bag:

1. Release the belt holding the last bag. Remove the holder, put in a new bag & pull out the inner end upwards.
2. Assemble the holder on to the machine and strap the opening facing upwards with the belt.
3. Pull down the outside end and close it using a zip tie.

All dust extractors can be used with continuous folding dust bags for single use. Also all models can be fitted with the continuous bag system.

Only change continuous bag or regular bag after filter cleaning cycle have been completed.

To operate the continuous bag:

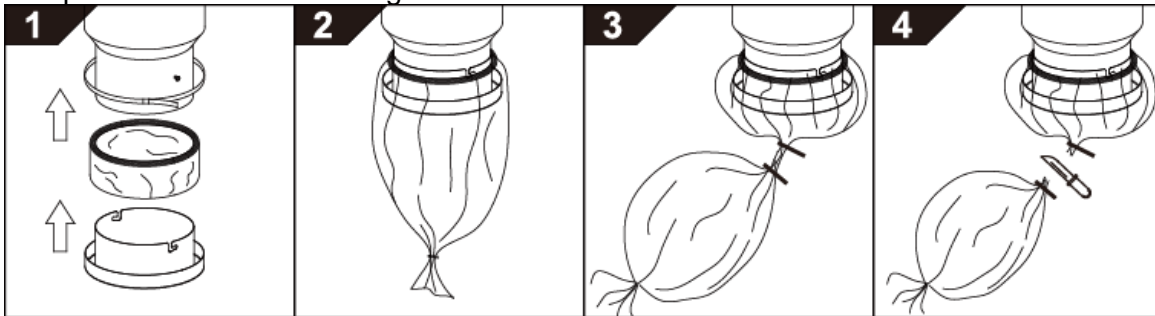

1. Assemble the continuous bag, turn on the machine.
2. Turn off the machine, the dust will drop down to the bags.
3. Use a nylon tie to seal the bag.
4. Cut the bag.

7.4 Filter Replacement

Risk of dust dispersion - Use personal safety equipment

Unhealthy dust can be spread during filter change. Accordingly, the user should wear protective glasses, protective gloves, and a breathing mask conforming to protection class FFP3.



WARNING

Remember to switch off the machine and pull the plug out of the outlet before servicing.

7.4.1 Replacing the prefilter

Loosen the 3 clamps and remove the top. Take the bag from the new filter.

Lift out the filter and place it gently in a plastic bag. This bag must be properly disposed.

Insert a new filter.

Important:

If you are removing the Pre-filter in order to clean it. Hitting the filter with force or use of compressed air will destroy the filter. It can handle water, but high-pressure water cleaning will destroy it.

7.4.2 Replacing the HEPA Filter

Loosen the two nuts on each filter cover cap. Carefully lift the filter into a clean plastic bag, use the bag from the new filter. This bag must be properly disposed. Insert a new filter in reverse order.

Important:

HEPA filters can't be cleaned, trying this might destroy it. When installing the replacement filter, make sure to not touch the inside of the filter. Any kind of force/damage on the inside of filter media will destroy the new filter.

8 Maintenance

- When cleaning and servicing the machine, you must switch off the machine and remove the plug from the outlet.
- Avoid cleaning with a high pressure cleaner. If necessary, do not direct at the openings on the machine, especially the opening for cooling air.
- Before moving the machine from the work area, the machine must be cleaned.
- All other equipment must be regarded as contaminated and be treated thereafter.
- If possible, use a special suitable room.
- Proper personnel protective equipment must be used. Dust can be spread when the coarse filter and the absolute filter are replaced that can be hazardous to health. Accordingly, the user should wear protective glasses, protective gloves, and a breathing mask conforming to protection class FFP3.
- All parts which are contaminated after service must be properly disposed of in plastic bags according to all regulations.
- If the machine has to be used for other purposes, it is extremely important that the machine is cleaned, to avoid the spread of hazardous dust.
- Do not puncture the HEPA filter. Risk of dust dispersion.

9 End of Product Life

Dispose of the machine and all accessories in accordance with the country's legislation.

To avoid harming the environment or your or others' health, it is recommended that you separate the machine from other waste and, if necessary, recycle it properly.

10 Breakdowns – Cause and Repair

10.1 Fault Tracking

The dust extractors are designed and manufactured for severe environments and tasks, but the user must note that the machine must be protected from knocks and blows. Filter, seals, attachments, and connections are carefully adapted and selected with regard to the operator's work environment. Therefore, the operator and service personnel must treat the machine with care in order for it to work correctly for many years.

Issue	Cause	Solution
Motor doesn't start	No Power	Plug in machine
	Cable defective	Replace cable
	Switch defective	Replace switch
Motor stops immediately after starting	Shortcut in cable/machine	Order service
Motor runs but there is no suction	Hose not connected	Connect hose
	Hose clogged/blocked	Clean hose
	No dust collection bag	Fit dust collection system
Motor runs but poor suction	Hole in hose	Replace hose
	Filter clogged	Clean filter/Replace filter
	Loose top cover	Adjust
	Defective gaskets	Replace affected gaskets
Dust blown from motor	Wrongly assembled or damaged filter system	Adjust/Replace filters
Abnormal noise		Order service

Any other problem please contact supplier.

10.2 After-sales service

When ordering spare parts, always indicate:

- a. Serial number (seven digits)
- b. Part Number
- c. Exact description
- d. Number of pieces desired
- e. Exact address
- f. Please avoid statements such as "as soon as possible" or "urgent" but clearly indicate the desired shipping method: "express", "by air", etc.

If you do not specify the desired shipping method, we will send the parts by the means considered the most reasonable, without necessarily being the fastest.

With accurate instructions, you will avoid problems and shipping errors.

If there is any uncertainty, please send us the defective part.

In the event that the parts are covered by the warranty, the shipment of the defective part is mandatory.

Order engine parts directly from the manufacturer or from a representative – you'll save time and money!

This machine was manufactured by Saint-Gobain Abrasives S.A.:

190 J. F. Kennedy Blvd.

L-4930 BASCHARAGE

Grand Duchy of Luxembourg

Tel.: 00352 50 401 1

Fax. : 00352 50 16 63

<http://www.construction.norton.eu>

E-mail: sales.nlx@saint-gobain.com

10.3 Parts

To view spare parts lists, please visit the Norton Clipper Aftermarket website at the following address:

<https://spareparts.nortonabrasives.com>

For quick access, you can also use the QR Code below using your mobile phone:



This electronic catalog provides you with exploded parts and spare parts lists for various Norton Clipper machines so that you can find the part numbers you need.

You can get technical support, spare parts and diamond blades from our local distributors.

SAINT-GOBAIN ABRASIVES
INDUSTRIEWEG 21
9420 ERPE-MERE
BELGIUM
TEL: +32(0) 2 267 21 00

SAINT-GOBAIN CONSTRUCTION
PRODUCTS CZ A.S
DIVIZE ABRASIVES
SMRČKOVA 2485/4
180 00 PRAHA 8
TEL: +420 255 719 326 FAX: +420 255 719
321

SAINT-GOBAIN ABRASIVES A/S
DYBENDALSVÆNGET 2,
DK-2630 TAASTRUP
DENMARK
TEL: +45 4675 5244

PO BOX 643706
FORTUNE TOWER OFFICE 2106
JLT BLOCK C
(NEXT TO METRO STATION)
JUMEIRA LAKE TOWER, DUBAI
UNITED ARAB EMIRATES
TEL: +971 4 431 5154
FAX: +971 4 431 5434

SAINT-GOBAIN ABRASIVES
RUE DE L'AMBASSADEUR - B.P.8
78 702 CONFLANS CEDEX
FRANCE
TEL: +33 (0)1 34 90 40 00
FAX: +33 (0)1 39 19 89 56

SAINT-GOBAIN ABRASIVES GMBH
BIRKENSTRASSE 45-49
D-50389 WESSELING
GERMANY
TEL: +49 (0) 2236 703-0
FAX: +49 (0) 2236 703-730

SAINT-GOBAIN KFT ABRASIVES.
1225 BUDAPEST
BÁNYALÉG U. 60/B.
HUNGARY
TEL: +36 1 371 22 50
FAX: +36 1 371 22 55

SAINT-GOBAIN ABRASIVI S.P.A
VIA PER CESANO BOSCONI 4
I-20094 CORSICO MILANO
ITALY
TEL: +39 02 44 851
FAX: +39 02 44 78 266

SAINT-GOBAIN ABRASIVES S.A.
190 J.F. KENNEDY STREET
L-4930 BASCHARAGE
GRAND DUCHY OF LUXEMBOURG
TEL: +352 50 401 1
FAX: +331 83 717 792
NO. VERT (FRANCE): 0800 906 903

SAINT-GOBAIN ABRASIVES, S.A.
2 ALLÉE DES FIG TREES
AIN SEBAË - CASABLANCA
MOROCCO
TEL: +212 5 22 66 57 31
FAX: +212 5 22 35 09 65

SAINT-GOBAIN ABRASIVES BV
GROENLOSEWEG 28
7151 HW EIBERGEN
P.O. BOX 10
7150 AA EIBERGEN
THE NETHERLANDS
TEL: +31 545 466466
FAX: +31 545 474605

SAINT-GOBAIN ABRASIVES AS
KARIHAUGVEIEN, 89
0186 OSLO
NORWAY
TEL: +47 63 87 06 00
FAX: +47 63 87 06 01

SAINT-GOBAIN HPM POLSKA SP. Z O.O.
UL. NORTON 1, 62-600 KOŁO
POLAND
TEL: +48 63 26 17 100
FAX: +48 63 27 20 401

SAINT-GOBAIN ABRASIVOS, L. DA
ZONA INDUSTRIAL DA MAIA I-SECTOR
VIII, NO. 122
APARTADO 6050
4476 - 908 MAIA
PORTUGAL
TEL: +351 229 437 940
FAX: +351 229 437 949

SAINT-GOBAIN GLASS
BUSINESS UNIT ABRASIVI
PUNCT DE LUCRU : LOC. VETIS, JUD.
SATU MARE 447355
STR. CAREIULUI 11
INDUSTRIAL PARK RENOVATIO
ROMANIA
TEL: +40 261 839 709
FAX: +40 261 839 710

SG HPM RUS
58, F. ENGELS STR.
STROENIE 2
105082 MOSCOW
RUSSIA
TEL: +74 955 408 355
FAX: +74 959 373 224

SAINT-GOBAIN ABRASIVES (PTY) LTD
2 MONTEER ROAD
ISANDO 1600
P.O. BOX 67
SOUTH AFRICA
TEL: +27 11 961 2000
FAX: +27 11 961 2184/5

SAINT-GOBAIN ABRASIVOS, S.A.
CTRA. FROM GIPUZKOA, KM. 7,5
E-31195 BERRIOPLANO (NAVARRA)
SPAIN
TEL: +34 948 306 000
FAX: +34 948 306 042

SAINT GOBAIN ABRASIVES AB
GÅRDSFOGDEVÄGEN 18A
168 66 BROMMA • SVERIGE
SWEDEN
TEL: +46 8 580 881 00
FAX: +46 8 580 881 30

SAINT-GOBAIN INOVATIF MALZEMELER
VE ASINDIRICI SAN. TWITCH. ACE.
ALTAYÇEŞME MAH. ÇAMLI SOK. NO:21
ESAS OFİSPARK KAT:9 34843
MALTEPE, İSTANBUL • TURKEY
TEL: 0090-216-217 12 50
FAX: 0090-216-442 40 74

SAINT-GOBAIN ABRASIVES LTD.
UNICORN HOUSE UNIT 1, AMISON
CLOSE
REDHILL BUSINESS PARK
STAFFORD ST161WB
UNITED KINGDOM
TEL: +44 1785 279 553
FAX: +44 1785 213 487



Saint-Gobain Abrasifs
190 Rue J.F. Kennedy
L-4930 Bascharage
Grand Duche de Luxembourg
Tel: +352 50 4011
Fax: +331 83 717 792
no. vert (France) 0800 906 903

www.nortonabrasives.com/fr-fr